

RESOLUTION NO. 10-8

A RESOLUTION OF THE CITY OF WATHENA, KANSAS, DECLARING AND ESTABLISHING POLICY REGARDING CUTS MADE TO STREETS, PARKING LOTS, ALLEYS OR RIGHT-OF-WAYS AND REGARDING RESTORATION OF STREETS, PARKING LOTS, ALLEYS OR RIGHT-OF-WAYS WHICH HAVE BEEN CUT, DAMAGED OR OTHERWISE AFFECTED BY EXCAVATION WORK, CONSTRUCTION WORK, ACCIDENT OR MISTAKE.

WHEREAS, the Governing Body of the City of Wathena, Kansas, has determined it necessary to establish a uniform policy for the repair of damaged streets, parking lots, alleys or right of ways;

NOW, THEREFORE, BE IT RESOLVED AND DECLARED BY THE GOVERNING BODY OF THE CITY OF WATHENA, DONIPHAN COUNTY, KANSAS:

1. It is hereby decreed to be the policy of the City of Wathena, Kansas, that all cuts to any asphalt, concrete, brick or chip sealed streets, alleys or parking lots shall be made by way of saw cuts.

2. It is further decreed to be the policy of the City of Wathena, Kansas, that streets, parking lots, alleys or other public ways which are cut, damaged or otherwise affected by excavation work, construction work or as a result of accident or mistake shall be restored as follows:

(a) Asphalt streets, parking lots or alleys shall be restored in accord with the standards set forth in "Exhibit A" attached hereto and made a part hereof by reference.

(b) Concrete streets, parking lots or alleys shall be restored in accord with the standards set forth in "Exhibit B" attached hereto and made a part hereof by reference.

(c) Brick streets, parking lots or alleys shall be restored in accord with the standards set forth in "Exhibit C" attached hereto and made a part hereof by reference.

(d) Streets, parking lots or alleys which are chip sealed shall have the base restored in the same manner as prescribed for asphalt streets, however, the surface area may be restored with cold patch.

Resolution 10-8

Page 2

(e) Gravel streets, parking lots and alleys shall be re-graveled in such manner as to restore the street or alley to at least as good a condition as the same was in prior to the event necessitating restoration.

3. It is further decreed to be the policy of the City of Wathena, Kansas, that the non-traveled portion of any right-of-way which is cut, damaged or otherwise affected by excavation work, or as a result of accident or mistake shall be restored to a condition at least as good as the condition the same was in prior to occurrence of the event necessitating restoration.

4. It is further decreed to be the policy of the City of Wathena, Kansas, that prior to any cuts or other excavation work as described above, an application and \$10.00 excavation fee shall be submitted to the City Clerk of the City of Wathena, Kansas.

APPROVED AND ADOPTED on the 21st day of June, 2010.

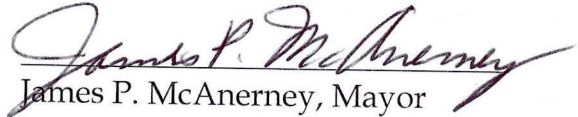
James P. McAnerney, Mayor

ATTEST:

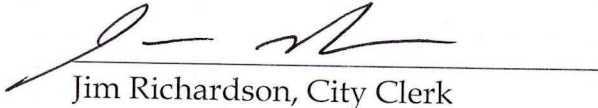
Jim Richardson, City Clerk

(CITY SEAL)

Exhibit A

LAN
137
107
40
20
111

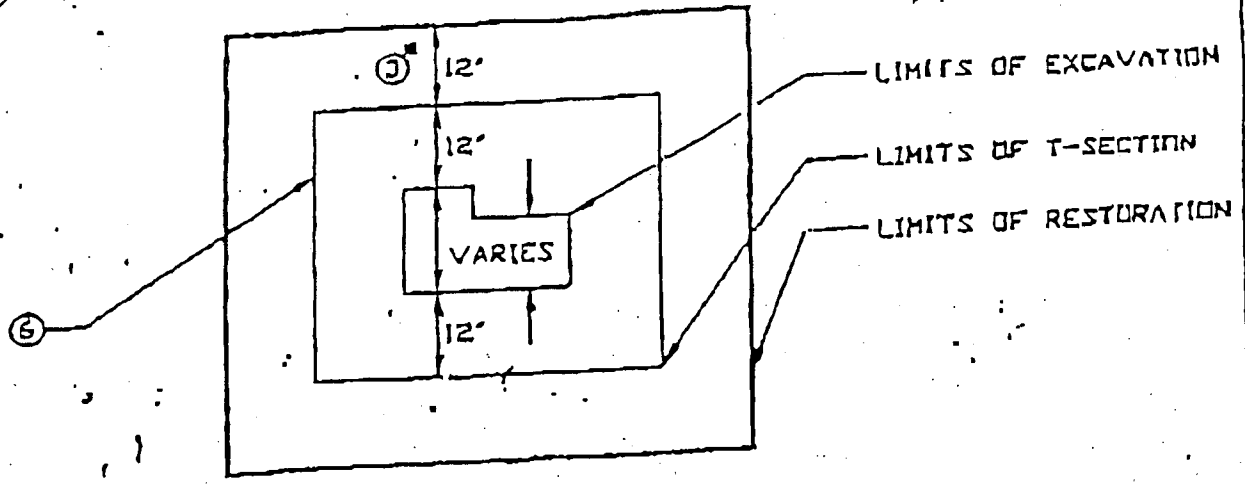

MURATORIUM STREETS ONLY

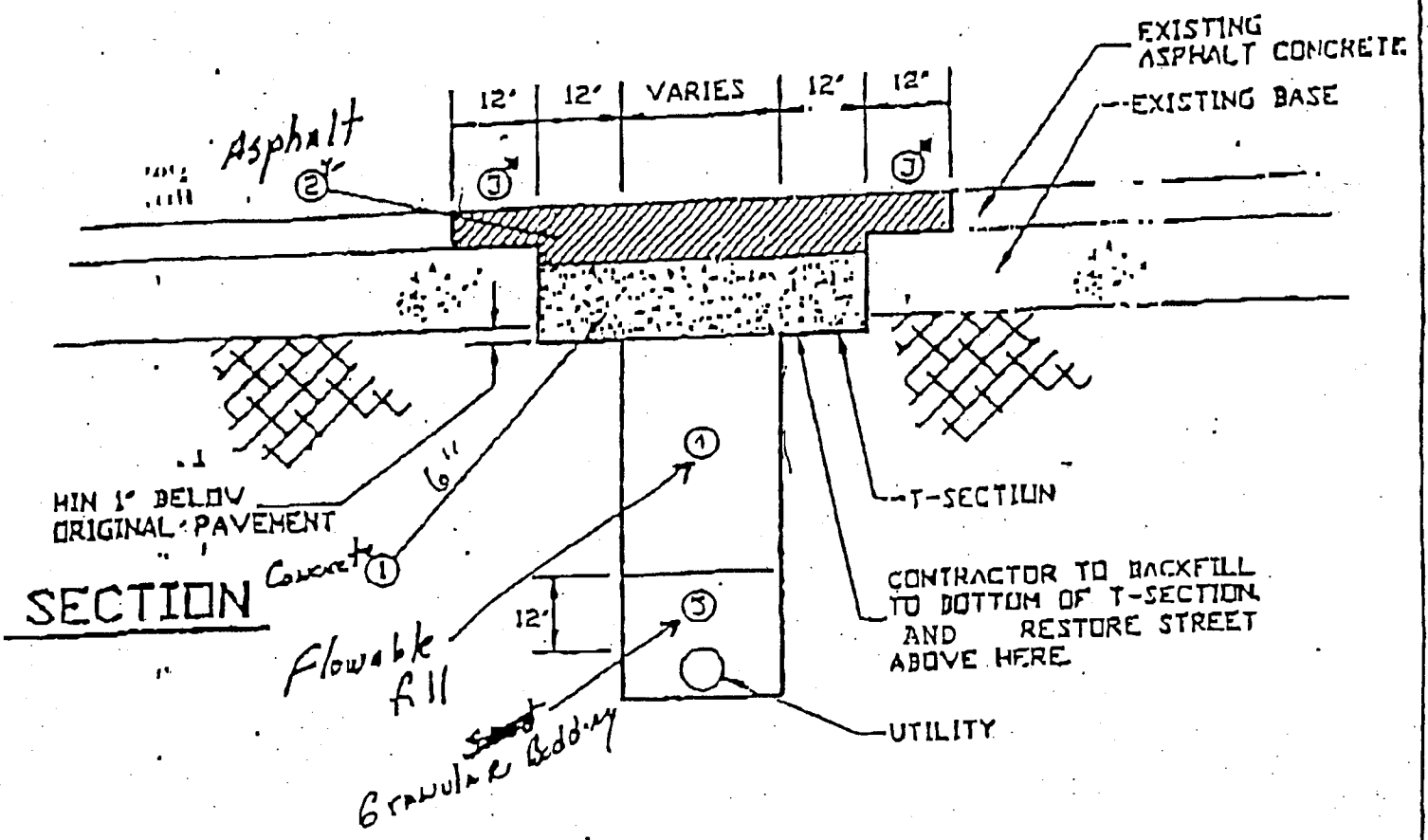

SECTION

CITY OF WATHENA

Street DEPT.

SCALE NONE

RESTORATION OF ASPHALT STREET EXCAVATIONS

DRAWING NO. SHEET 1 OF 2

DATE

... 5 ft. apart or less than 2 ft. ... concrete curb, gutter, or cross gutter, the restoration shall be continuous between excavations and ...

Exhibit B

PLAN

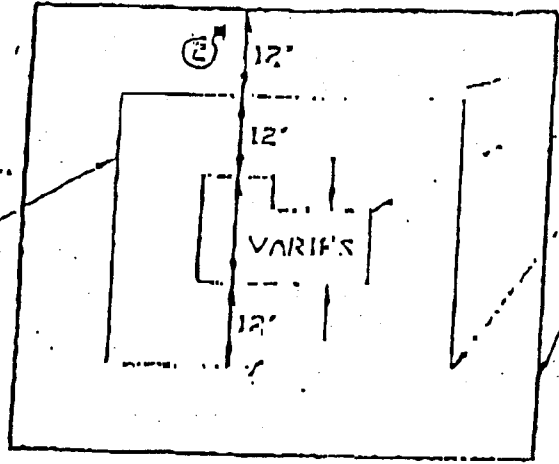

--- LIMITS OF EXCAVATION
 --- LIMITS OF SECTION
 --- LIMITS OF RESTORATION

Rebar?

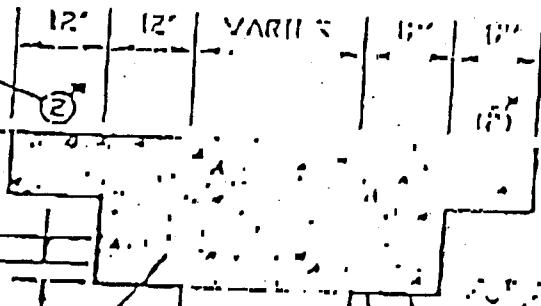

EXISTING CURB
 EXISTING ROAD

SECTION

MIN 1" BELOW ORIGINAL PAVEMENT

① concrete

Flowable fill

12"

③

④

CONTRACTOR TO BACKFILL TO BOTTOM OF T-SECTION AND RESTORE STREET ABOVE HERE.

Grouped subgrade

CITY OF WATHENA

Sheet 2 of 2
STREET DEPT.

RESTORATION OF CONCRETE STREET EXCAVATIONS

10:10

~~186-489-21~~

Exhibit C

PLAN

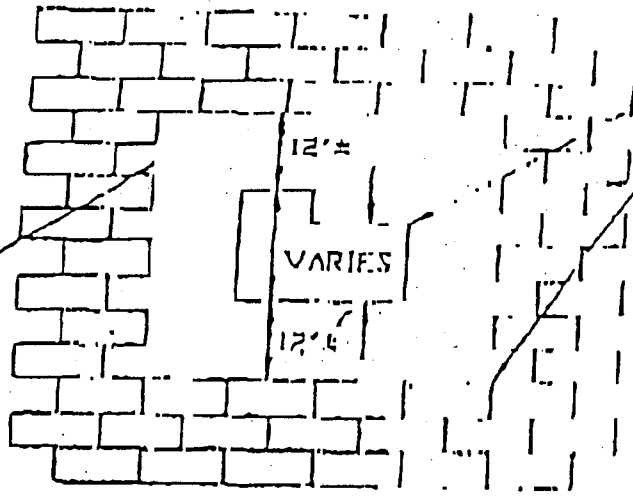

— LIMITS OF EXCAVATION
 - LIMITS OF T-SECTION

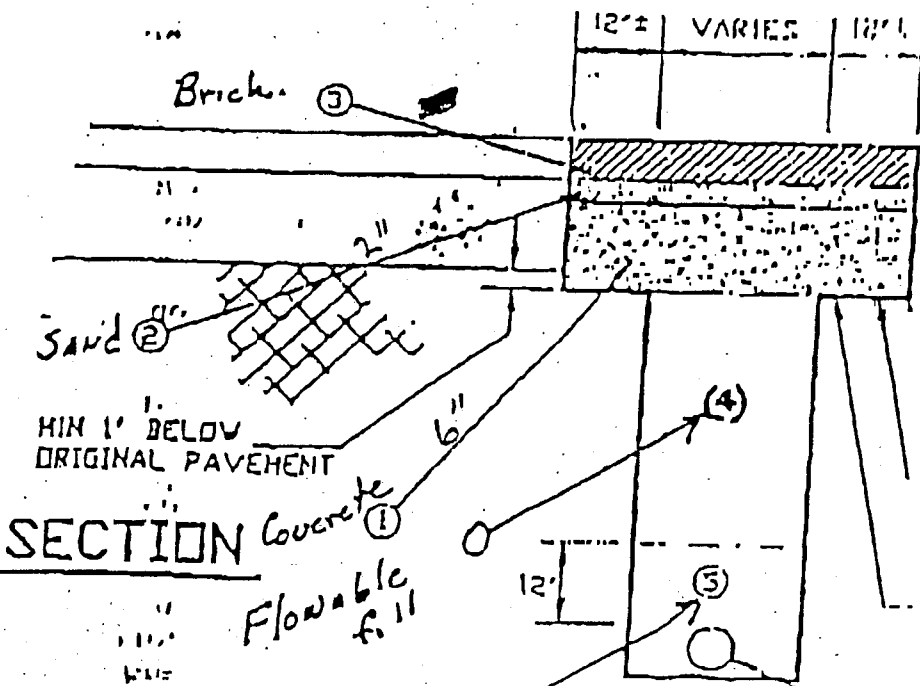

SECTION

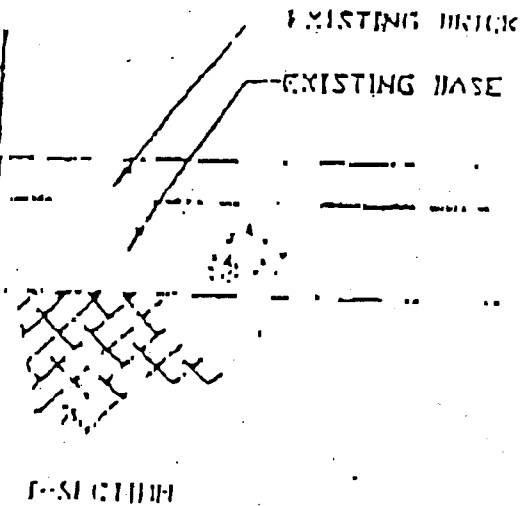

CONTRACTOR TO BACKFILL TO BOTTOM OF T-SECTION AND RESTORE STREET ABOVE HERE.

CITY OF WATKINA

Sheet 3 of 3
 Street DEPT.
 SCALE

RESTORATION OF BRICK STREET EXCAVATIONS